

Learning Center Tour

Voyager Hall, Epicenter, and Pluto





Welcome to Epic. As you explore, you'll see several ways in which we've created a productive, enjoyable work environment.

Innovative Campus

Our campus has:

- > **Private offices for productivity.** To solve complicated problems without distractions.
- > **Creativity and theming.** Joyful buildings = joyful software. The campus also helps us with hiring and retention.
- > **Low-rise buildings.** To promote in-person collaboration with face-to-face meetings, chance encounters, and personal relationships.
- > **Smart choices for lower costs.** Our office costs per employee are on the lower end of the national average. Rural Wisconsin also helps—and creates a wonderful environment!



While you are on your tour, remember that people at Epic are working on developing software to help keep people well, so please follow these instructions:



Be quiet in the halls.



Stick to the tour path.



Food and drinks on campus are for customers and staff.

CAMPUS

1,670 acres including...

- 410 acres of campus
- 750 acres of active farming

89 buildings

- 28 office buildings
- 3 food service buildings
- 2 learning campus buildings
- 1 greenhouse
- 14 utility buildings
- 8 maintenance buildings
- 5 parking ramps
- 27 farm buildings
- 1 tree house



SUSTAINABILITY

Green roofs

- 39 acres

Solar power

- 1.75 MW

Geothermal

(ground source heating and cooling)

- 27,000 tons capacity
- 7,500 wells
- 2 lakes

Wind turbines

- 6 at 1.65 MW each (total of 9.9 MW) – enough to power 10,000 homes!



FUN FACTS

Working farm

- 42 sheep
- 40 cows
- 1 donkey
- 600 cow bikes
- 14 cow carts
- 2 fast slides
- 1 carousel
- 4 indoor auditoriums with almost 18,000 seats total
- 1 outdoor auditorium
- 4 dinosaurs
- 3 elephants
- 1 cave
- 1 train car



Want to add a bit of competitive fun to your tour?

Play Learning Center Bingo!

LEARNING CENTER

BINGO

Banana on a Spring	Betty Boop	Singing Cats	Superheros at the Movies	Flying Space Station
Horned Doe	Beanstalk	Balancing Ballerina	Guitar Man	Thinking Dragon
Blues Brothers	Centipede Playing Drums	Free Space	Couch with a Face	Cannon- Ball Man
Head Full of Heads	Darth Vader	Neon Robot	John Lennon	Dobby the House Elf
Dog Balancing Ball	Giant Chicken	Kangaroo Playing Banjo	Bottlecap Furniture	Dog on a leash

Welcome to Epic. We hope you enjoy your self-guided tour.

Please remember Epic is a business, and we ask you to follow a few simple rules:

1. Please be quiet in the halls, so people can work without distraction.
2. Please stick to the tour path and don't wander off into other halls, into break rooms, etc.
3. Please don't eat the food (for example, cookies) or drink the beverages (for example, coffee or juice). They are for staff.
4. Please do not eat lunch in our cafeteria. The cafeteria is for staff.

Thanks for your attention to these requests.

If at any point you become turned around, please feel free to ask any Epic employee for directions.

Start at the Voyager Hall reception area.

1

Voyager Hall

Voyager Hall is named after the Voyager I spacecraft launched in 1977. It serves several purposes, but its main goal is to help our customers and our staff become knowledgeable in Epic software.

As you walk forward you will see Mir Commons, named after the Soviet space station.

Head to the right on Level I toward Epicenter. You should pass the Epic Trek, Camelot, and 2007 training rooms on your left.

Voyager Hall consists of classrooms, computer labs, cafeterias, and lounges.

The large training rooms are named and themed after past Users' Group Meetings (UGM). Smaller training rooms are named after space probes (e.g. Hubble, Mariner, Pioneer) and break rooms are named after spaceships (e.g. Apollo, Discovery).

Every week, hundreds of Epic and customer staff attend classes in these rooms.



**Walk until you see the theater marquee on your left.
Enter to visit Epicenter.**

Epicenter is our 5,600-seat auditorium that can be divided into three separate 1,800-seat sections (Shake, Rattle, & Roll) when needed. It is used for larger team meetings, management meetings, advisory councils, and seminars. It is also used each spring for Verona Area High School's graduation ceremony.



As you continue to walk through the Epicenter Lobby, you will see a wall of hands. These are handprints of employees who have been with Epic for 10 years or more.



Beyond Epicenter is the entrance to our newest auditorium, Deep Space. We use Deep Space for our monthly all-Epic staff meeting, which has been an integral part of Epic's culture for decades. During the meeting, we introduce new customers, celebrate successes, discuss challenges, teach philosophy & culture, and highlight a particular role each month so that we learn more about each others work.

Another significant event held here is our annual Users' Group Meeting (UGM) where each September, thousands of our customers join Epic staff for a weeklong conference.



Continue walking past Deep Space, following the curvature of the building, until you reach Pluto. This section of training rooms along the back side of Epicenter was added in September of 2011.

Walk through Pluto past several training rooms on your right. You should see banners for Rock IT, Once Upon a Time, and The Musical. Continue until you reach Galileo Commons on your left. Take the feature stairs to Level 2.

Once on Level 2, head across the hall to the Gemini break area to take in the view.

Office buildings occupy only a small fraction of our roughly 1,000 acres. Much of the additional space is cropped with alfalfa, soybeans, and corn or is used for cattle grazing.

Green Fact: Beneath the “backyard” of Voyager Hall lies one of the largest closed-loop geothermal installments in the country. Several thousand geothermal wells dug 300-500 feet deep assist with heating and cooling Epic’s office buildings. This area is also home to our annual Epicnic.

As you leave the break area head to your right.

Continue walking past the UGM 2015 and UGM 2016 training rooms. These names will be changed in the future to match the UGM theme for that year. Continue walking until you reach Voyager Hall where you’ll turn right.

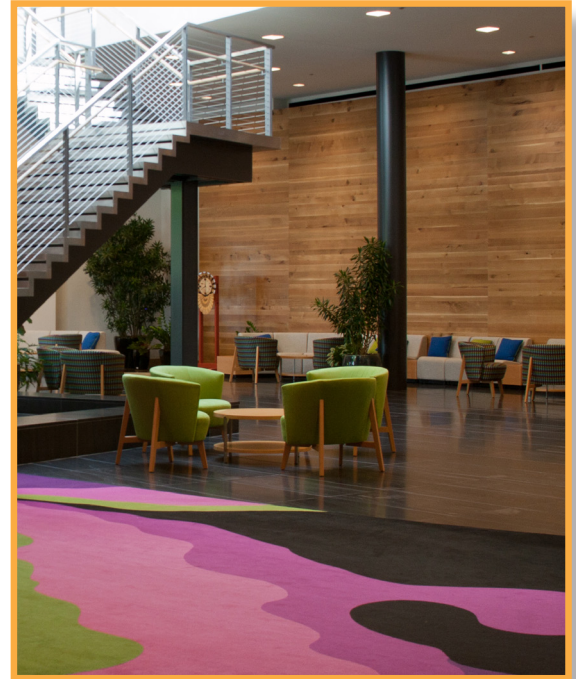

Now back in Voyager Hall, continue walking past the **Middle Earth, Much Ado About Healthcare, and Mystery In The Midwest** training rooms until you reach the **Skylab Commons**.



Option Point:

- To complete the shorter tour take the escalators down to Level 1 where you will see the Voyager Hall reception area.
- To continue the full tour, keep walking on Level 2 past **Odyssey, The Roaring '20s, Star Wars, and Superheroes** themed training rooms until you reach **The Bridge** lounge area.

Here you will be overlooking the Observation Deck, our multi-use conference hall.
The Observation Deck plays host to several gatherings throughout the year.

Take the stairs down to Level 1 and head to your right past the **Indiana Jones, History Of The Future and Greatest Show on Earth** training rooms until you return to the **Voyager Hall** reception area.

